

Chapelle Savoyarde

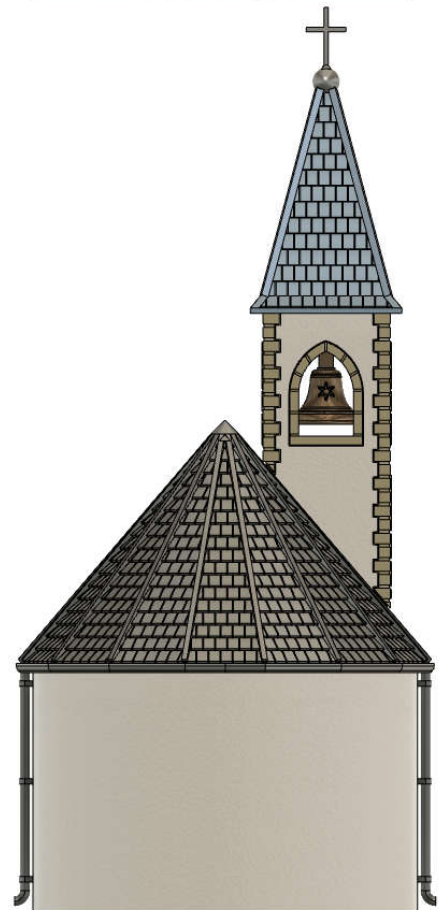

Chapelle Savoyarde

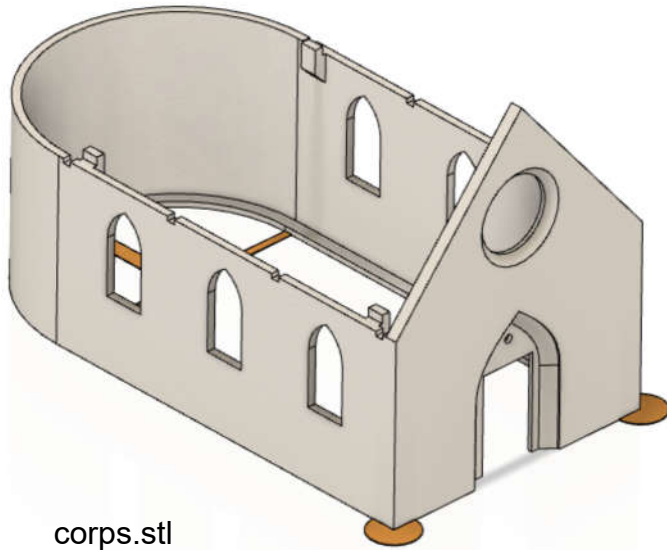

corps.stl

Les parties oranges sont à retirer. Elles servent à maintenir les pièces pendant l'impression .



0.25 mm

Pièces à imprimer avec une buse de 0.25 mm



0.4 mm

Pièces à imprimer avec une buse de 0.4 mm

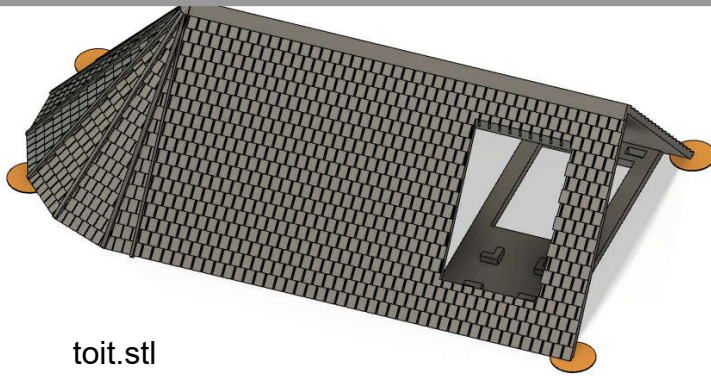

toit.stl

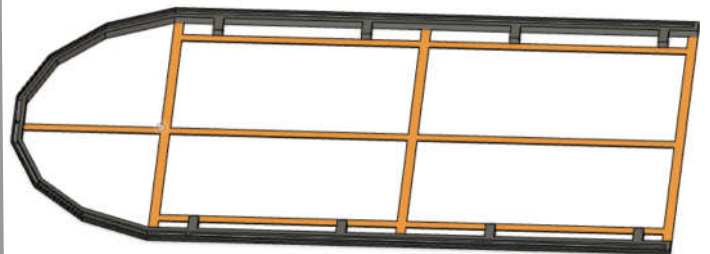

chaineau.stl

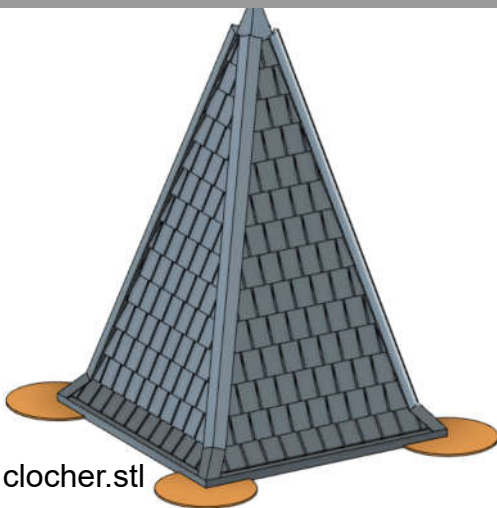

toit clocher.stl

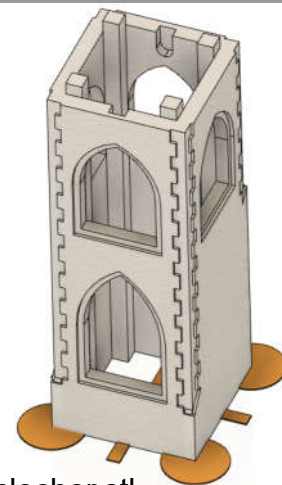

clocher.stl

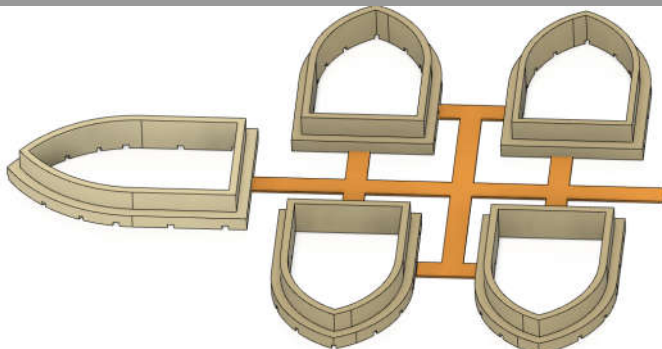

encadrement clocher.stl

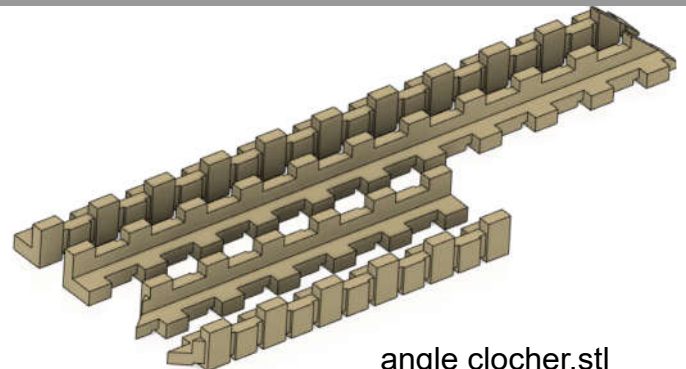

angle clocher.stl

Chapelle Savoyarde

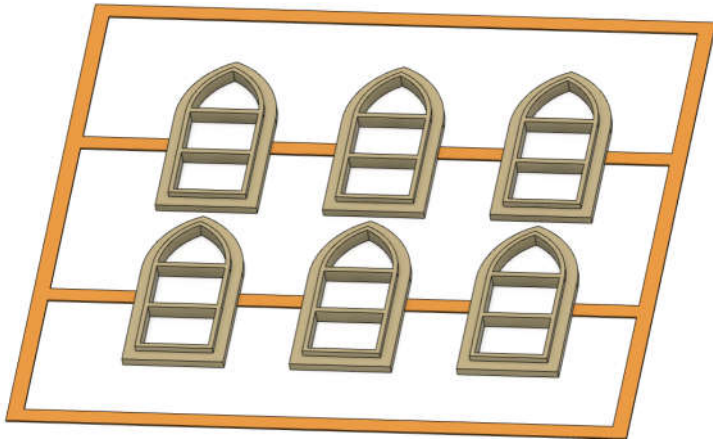

vitraux lateraux.stl



vitrail rond.stl

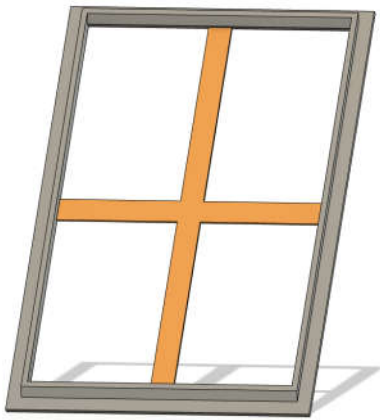

joint clocher.stl



cloche.stl

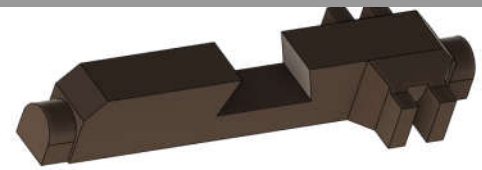

poutre cloche.stl

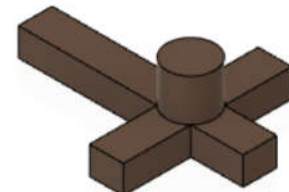

croix.stl



porte.stl



descente.stl



croix clocher.stl

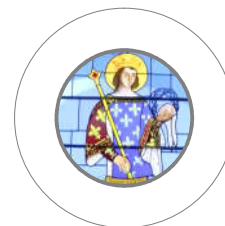
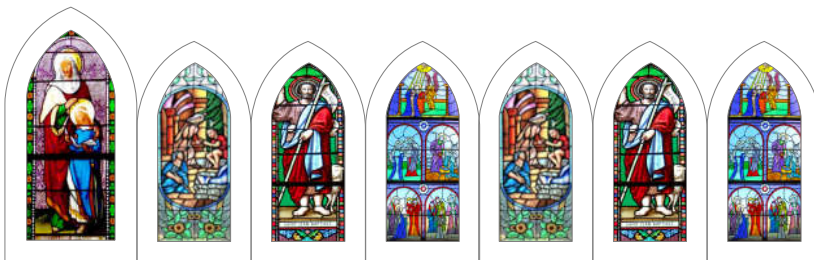

à imprimer échelle 1
sur transparent

vitrail.png

Chapelle Savoyarde

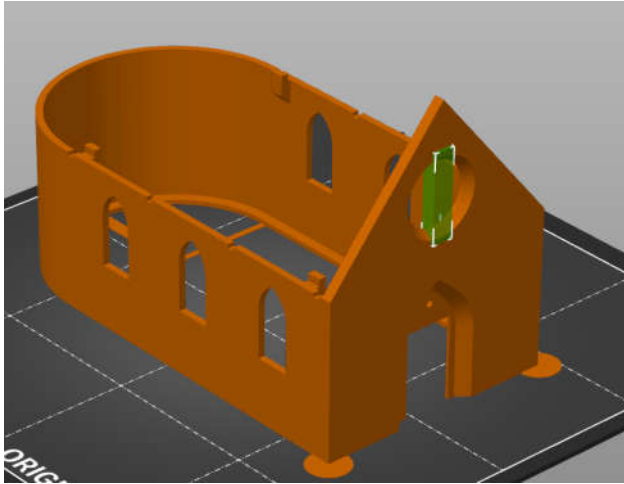

Placer un support pour le vitrail supérieur

Couche 0.2 mm
support partiel
Fill 10 %
PLA blanc
corps.stl



0.4 mm

ORIGINAL PRUSA MINI

Couche 0.2 mm
sans support
Fill 10 %
PLA argent
toit.stl



0.4 mm

Couche 0.2 mm
sans support
Fill 10 %
PLA blanc
clocher.stl



0.4 mm

Couche 0.05 mm
sans support
Fill 10 %
PLA argent
chaineau.stl



0.25 mm

Couche 0.1 mm
sans support
Fill 10 %
PLA beige
encadrement clocher.stl



0.25 mm

Couche 0.1 mm
sans support
Fill 10 %
PLA beige
angle clocher.stl



0.25 mm

Chapelle Savoyarde

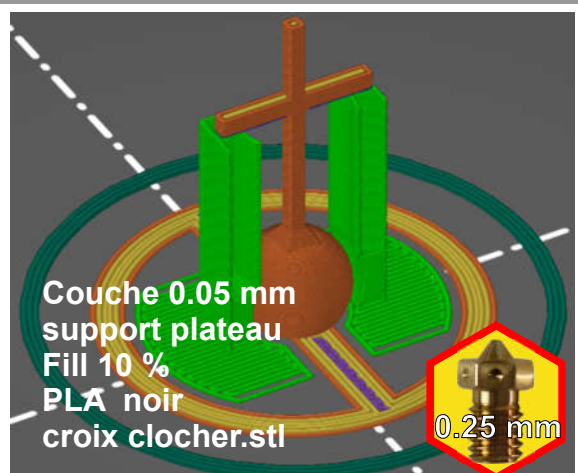
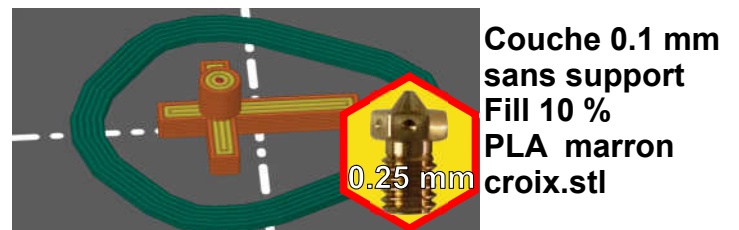
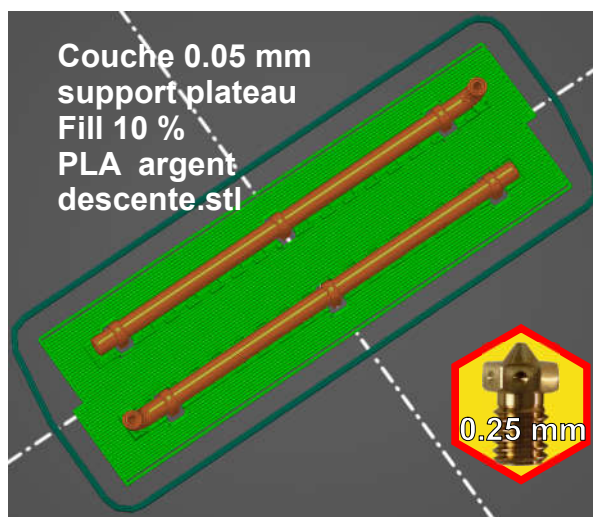
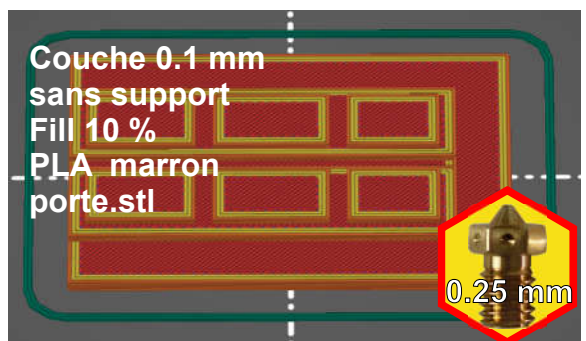
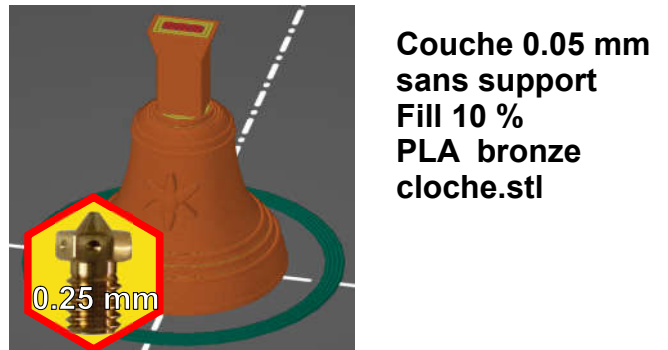
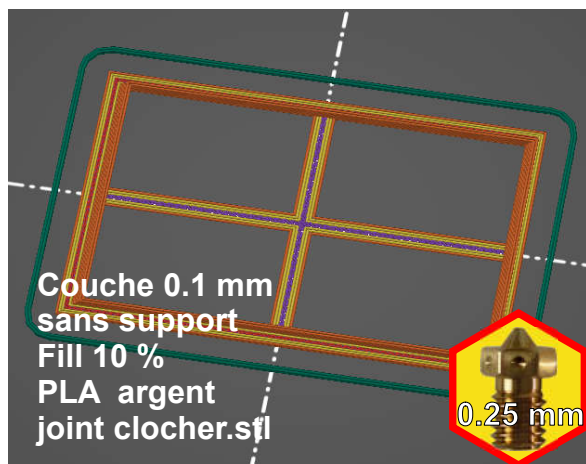
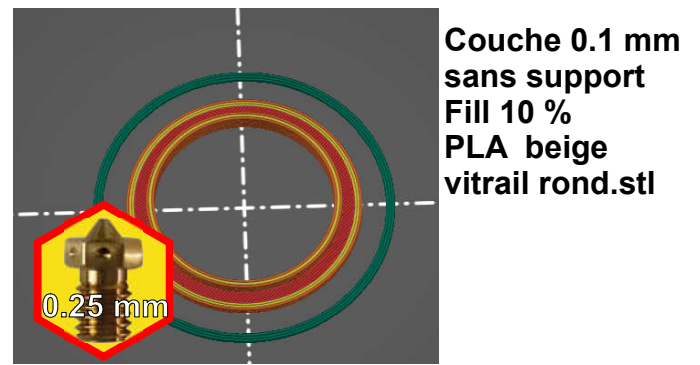
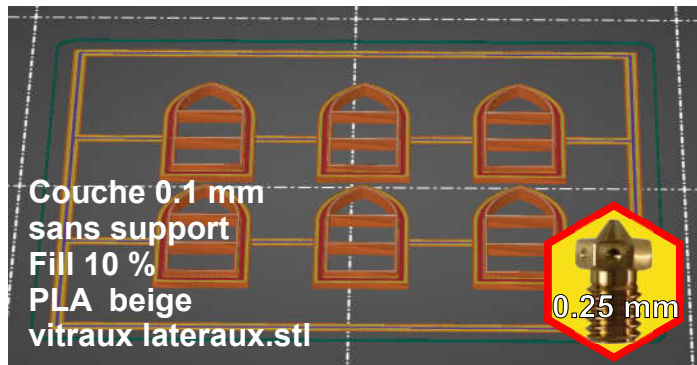

Chapelle Savoyarde

1



2



Chapelle Savoyarde

3

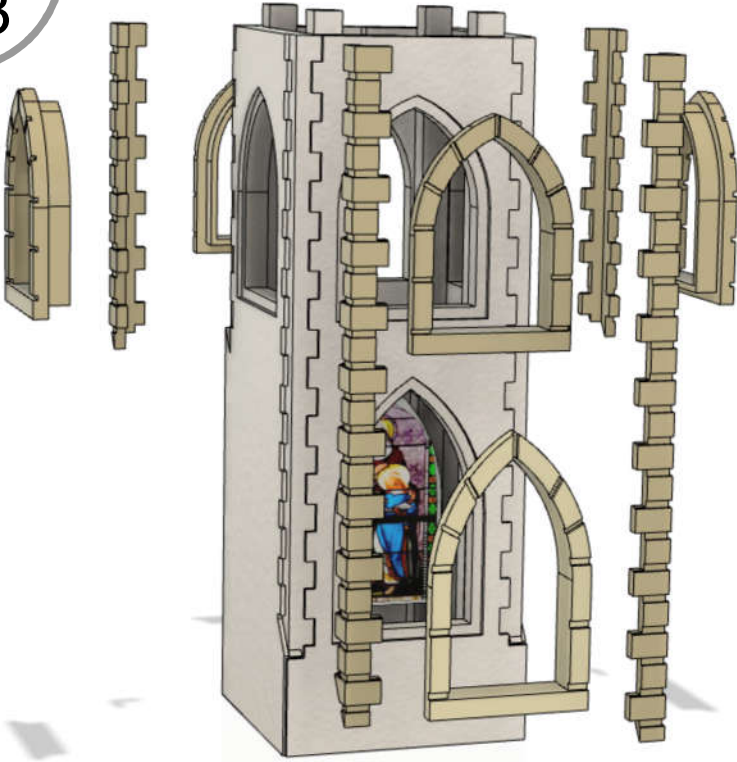

4



5



6

