

Arret autocar

Version Longue

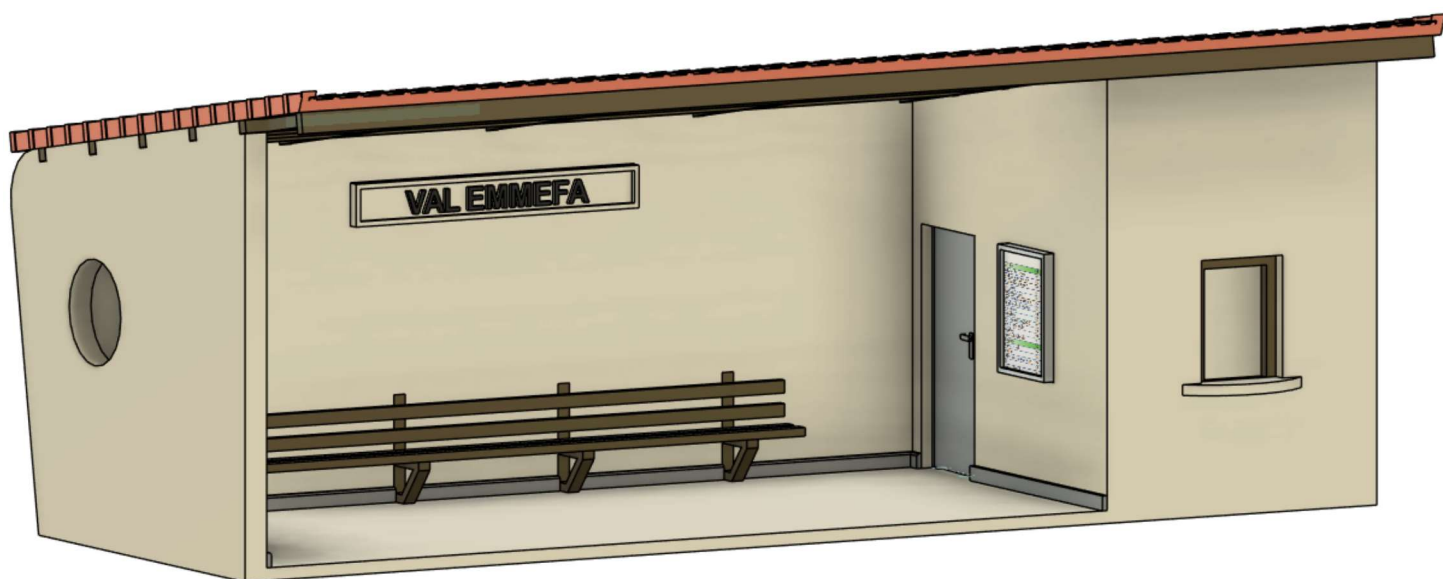
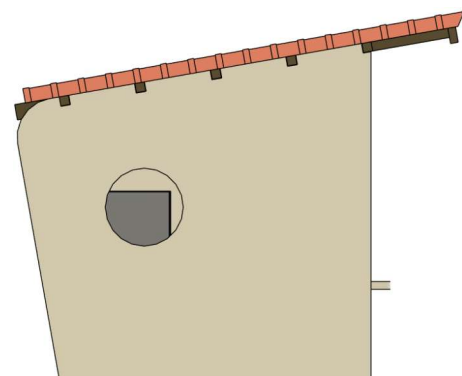
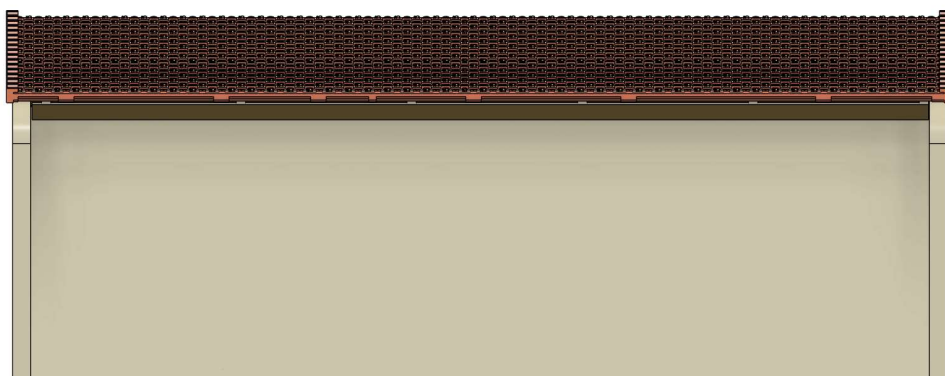
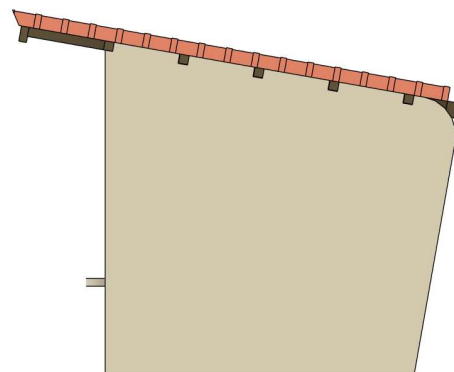
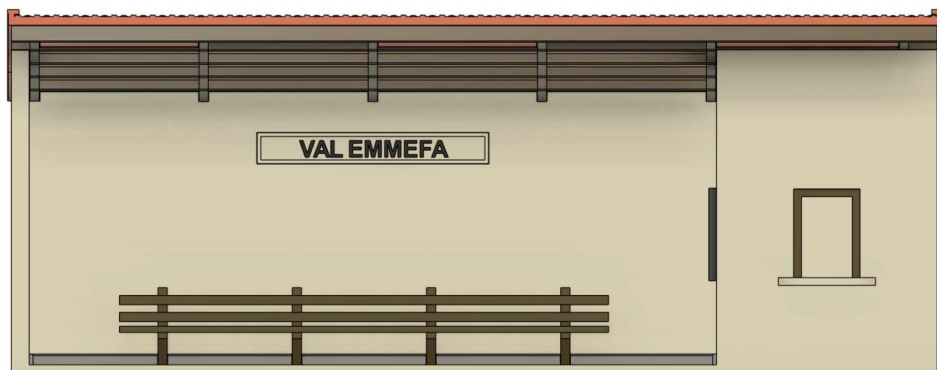

Arret autocar

Version Courte



Arret autocar



En rouge des aides à l'impression à supprimer
Utiliser un cutter bien aiguisé



A imprimer avec une buse de 0.25 mm maximum



A imprimer avec une buse de 0.4 mm maximum

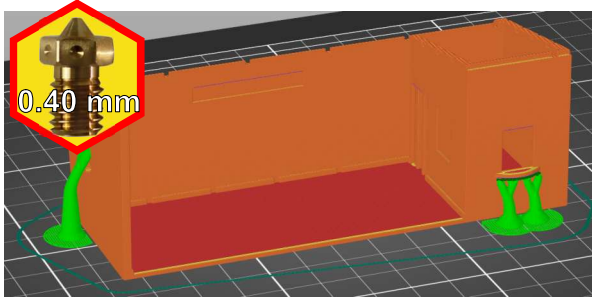

Couche 0.1 mm
Support plateau organique
remplissage 10 %
Pla gris ciment

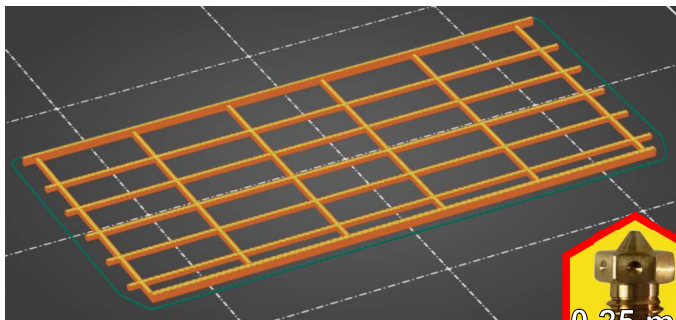
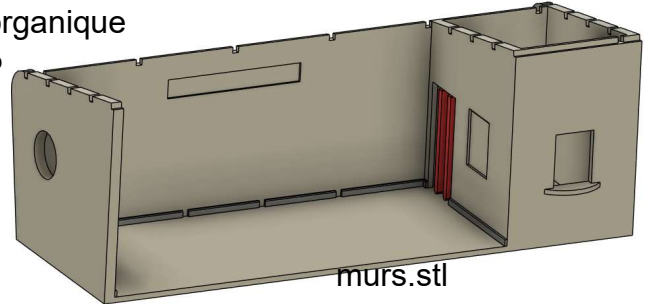

Couche 0.1 mm
sans support organique
remplissage 10 %
Pla marron



poutres.stl

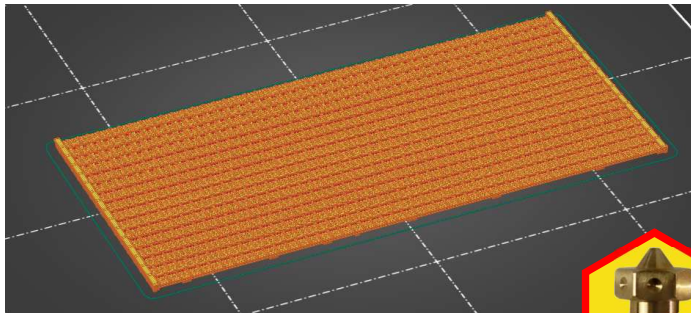

Couche 0.05 mm
sans support
remplissage 10 %
Pla tuile

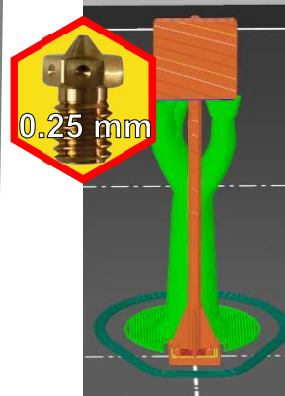

Couche 0.1 mm
Support plateau organique
remplissage 10 %
Pla gris ciment

panneau arret autocar.stl

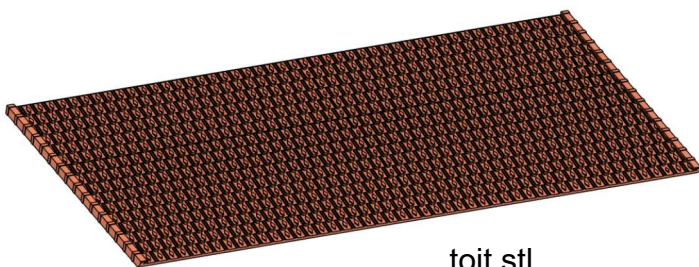

toit.stl

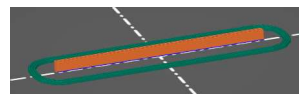

Couche 0.05 mm
sans support
remplissage 10 %
Pla tuile

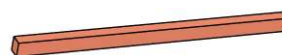

clef toit.stl *
* version fdm uniquement

Arret autocar

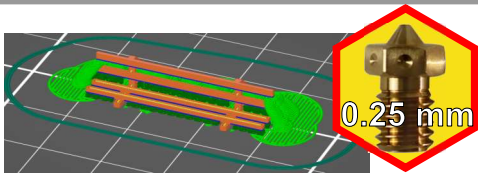

Couche 0.1 mm
Support plateau organique
densité des branches 10 %
remplissage 10 %

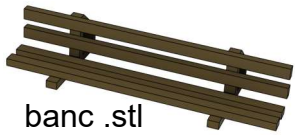

banc .stl

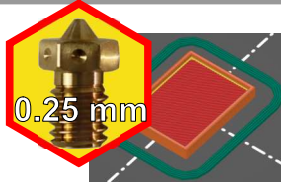

Couche 0.1 mm
sans support
remplissage 10 %
Pla gris ciment



horaires.stl

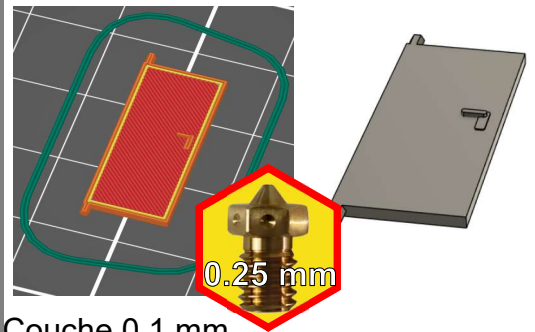

Couche 0.1 mm
sans support
remplissage 10 %
Pla gris ciment

porte.stl

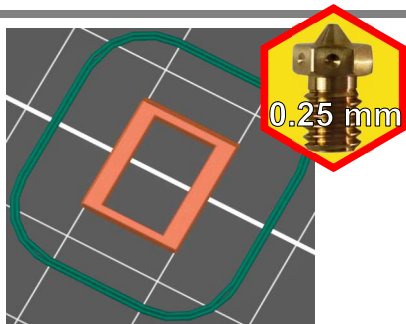

Couche 0.1 mm
sans support
remplissage 10 %
Pla marron

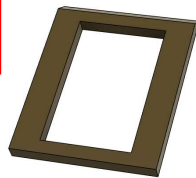

fenetre.stl

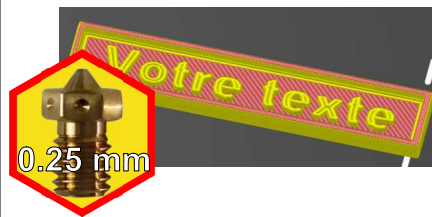

Couche 0.1 mm
sans support
remplissage 10 %
Pla gris ciment

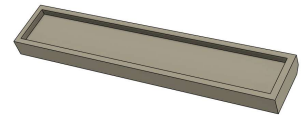

panneau.stl

Pour ajouter du texte au panneau, clic droit ajouter une pièce option Texte Réglages

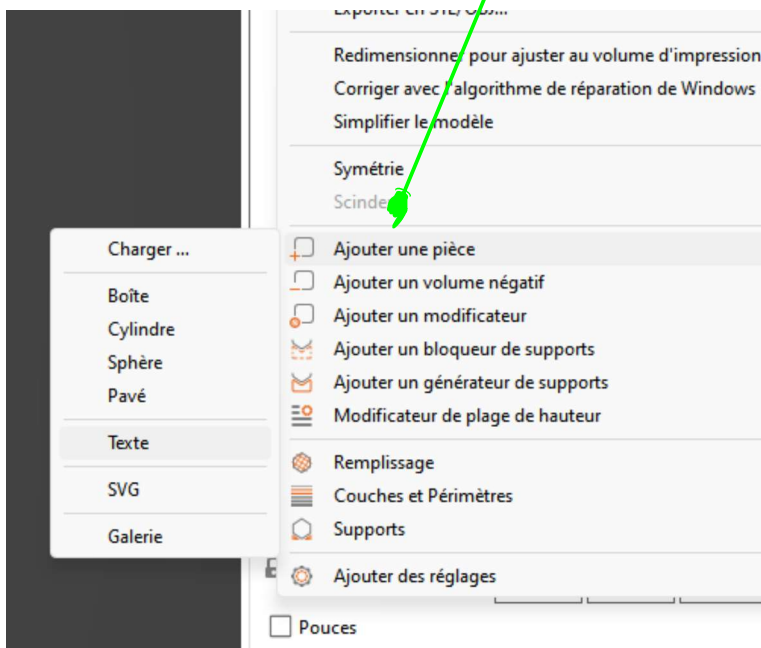

Arret autocar

Nota : le montage de la version courte et longue est identique
Note: The assembly of the short and long version is identical.

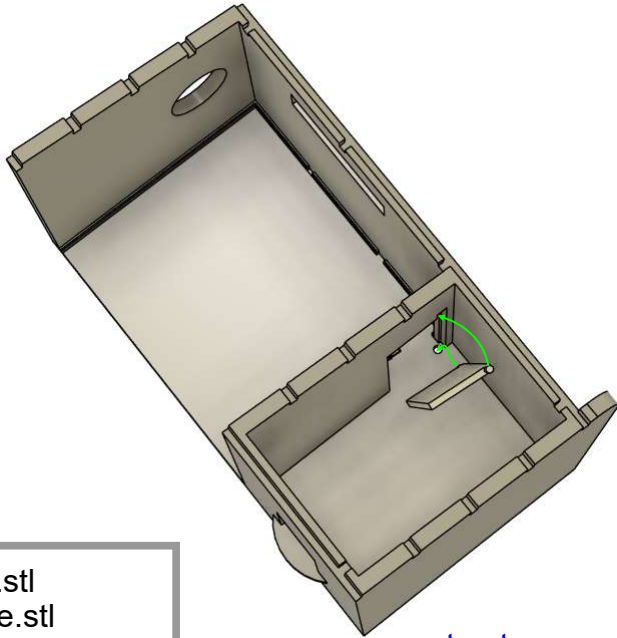

mur.stl
porte.stl

arret autocar

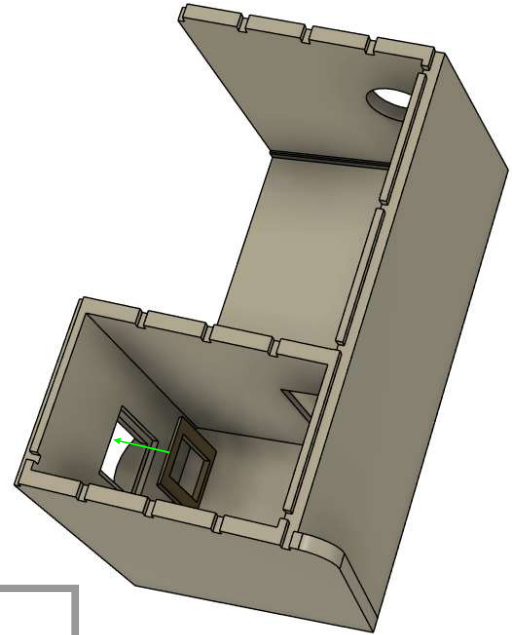

fenetre.stl
arret autocar

arret autocar

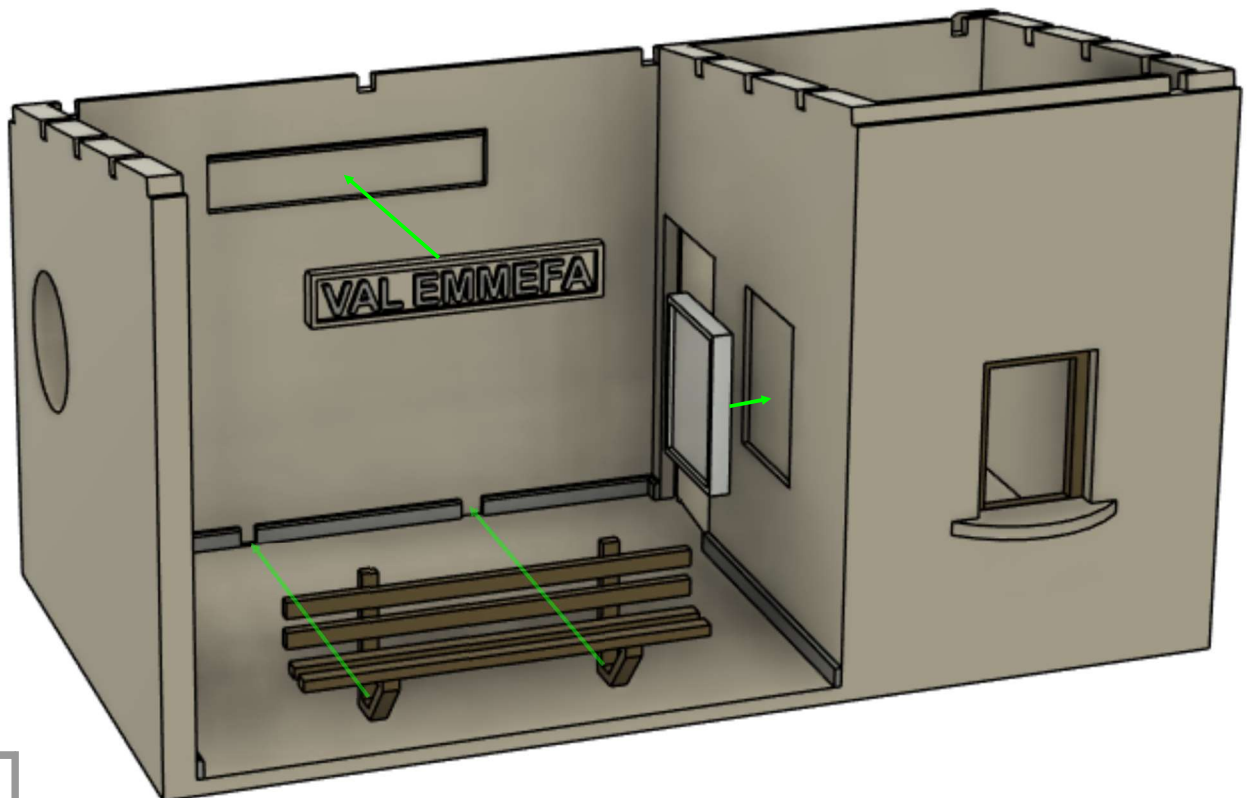

banc.stl
panneau.stl
horaires.stl
arret autocar

arret autocar

Arret autocar

Version fdm uniquement
Only for fdm version

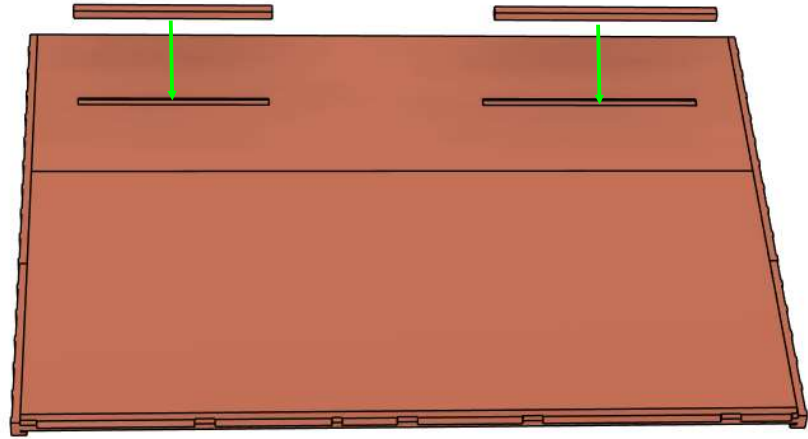

toit

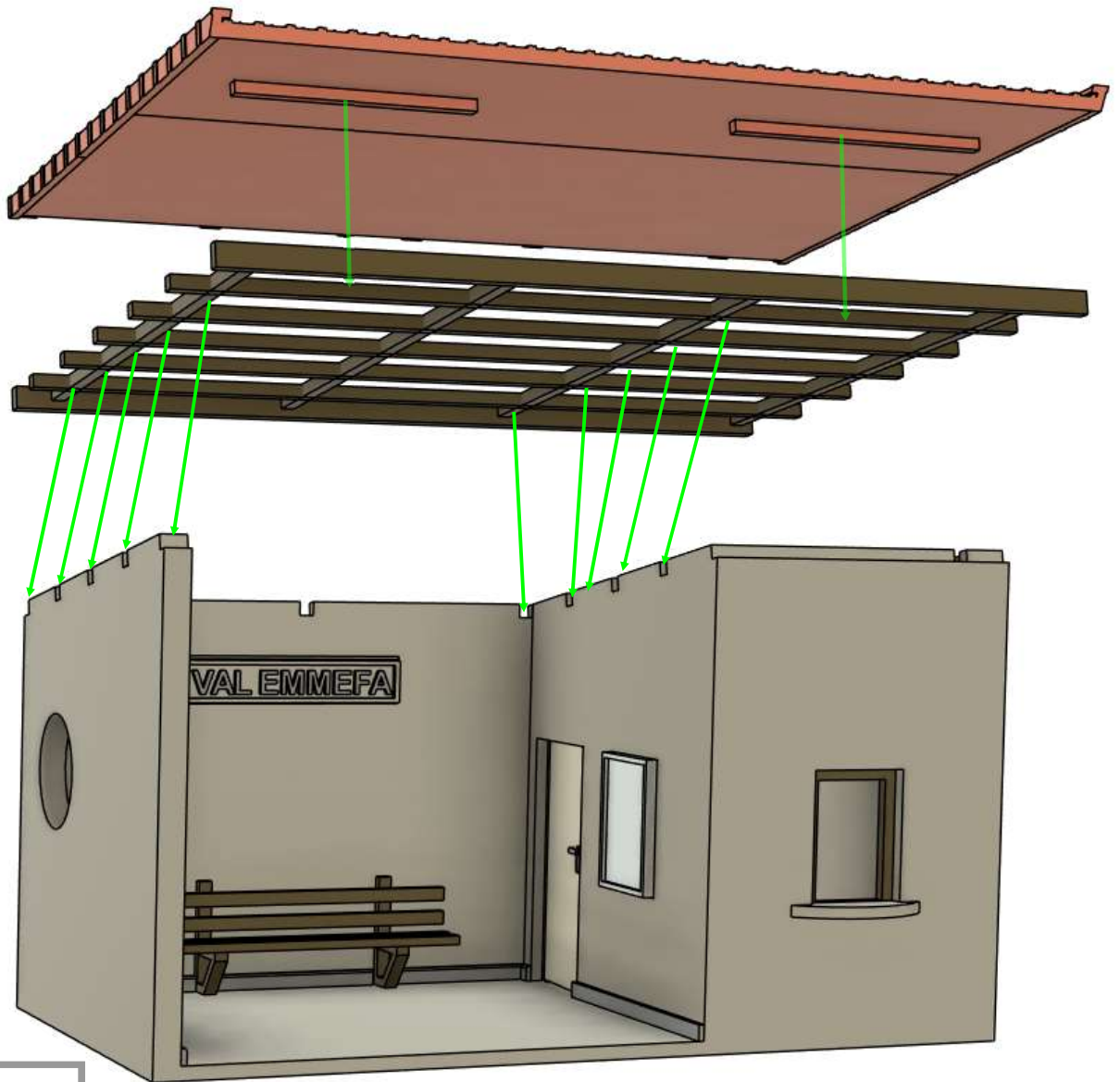

toit
poutres.stl
arret autocar